



## City of Lake Park, Iowa Application for Zoning Compliance Permit

For questions, please contact Marie Matthiesen Zoning Administrator 712-832-3527

### 1. LOCATION OF PROPOSED IMPROVEMENTS

Street Address \_\_\_\_\_ Zoning Classification \_\_\_\_\_  
Legal Description \_\_\_\_\_ (Lot) \_\_\_\_\_ (Block) \_\_\_\_\_ (Subdivision)

### 2. APPLICATION IS MADE BY

Name: \_\_\_\_\_ owner/developer/agent  
(Please circle one)

If applicant is not the owner, please list owner's name and address: \_\_\_\_\_

Street Address: \_\_\_\_\_

City, State, Zip: \_\_\_\_\_

Phone or Contact Number: \_\_\_\_\_

Contractor (Name & Phone #): \_\_\_\_\_

### 3. REASON FOR ZONING PERMIT

This permit is for: \_\_\_ New Construction \_\_\_ Fence \_\_\_ Driveway \_\_\_ Sign  
\_\_\_ Structural Alterations \_\_\_ Building Addition \_\_\_ Move/Relocate Bldg.

Please specifically describe the proposed building activities for this permit application  
(e.g. build new house, erect new garage, etc.; and please provide type of construction and building dimensions)

\_\_\_\_\_  
\_\_\_\_\_

Size and total square feet of the proposed structure or building: \_\_\_\_\_

Height of proposed structure or building: \_\_\_\_\_

(Note: Height of a building or structure is that distance measured from the ground level to the highest point)

Valuation of proposed structure or building: \$ \_\_\_\_\_

Exterior Wall Material \_\_\_\_\_

Roof Material \_\_\_\_\_

### 4. LOT OR PARCEL INFORMATION

Lot Size \_\_\_\_\_ (sq.ft.) Front Lot Width \_\_\_\_\_ Rear Lot Width \_\_\_\_\_ Lot Depth \_\_\_\_\_

Structure will be set back \_\_\_\_\_ feet from FRONT lot line

Structure will be set back \_\_\_\_\_ feet from REAR lot line

Structure will be set back \_\_\_\_\_ feet from LEFT SIDE and \_\_\_\_\_ feet from RIGHT SIDE

Structure will be set back \_\_\_\_\_ feet from nearest structure/building on the lot (occupied or unoccupied)

Present Land Use: \_\_\_\_\_ Proposed Land Use: \_\_\_\_\_

**City of Lake Park**  
**Zoning Compliance Permit - Site Plan -**

Applicant: \_\_\_\_\_

Property Address: \_\_\_\_\_

The City is not responsible or liable for the following:

1. To locate or survey the parcel on which construction is planned
2. To identify or confirm dimensions, corners, or curves of plated lot
3. To identify or confirm dimensions, location, duration of easement
4. To calculate and design storm water detention, retention, or run-off
5. To design or confirm compliance with subdivision covenants.

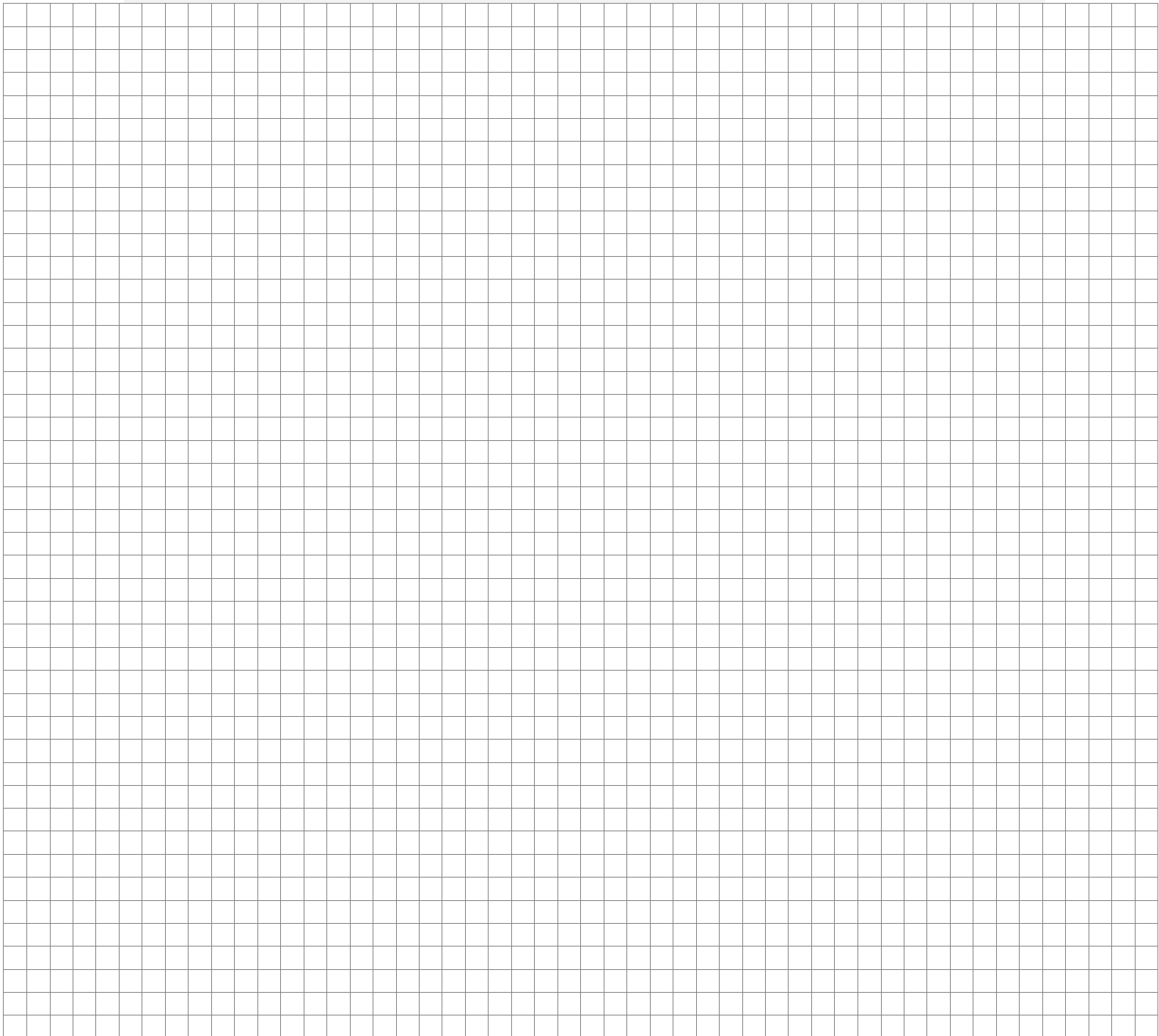

Scale: One box equals two feet (2'), unless otherwise specified. Attach additional pages if necessary.

*See the following page for sample site plan*

# PLOT PLAN SAMPLE:

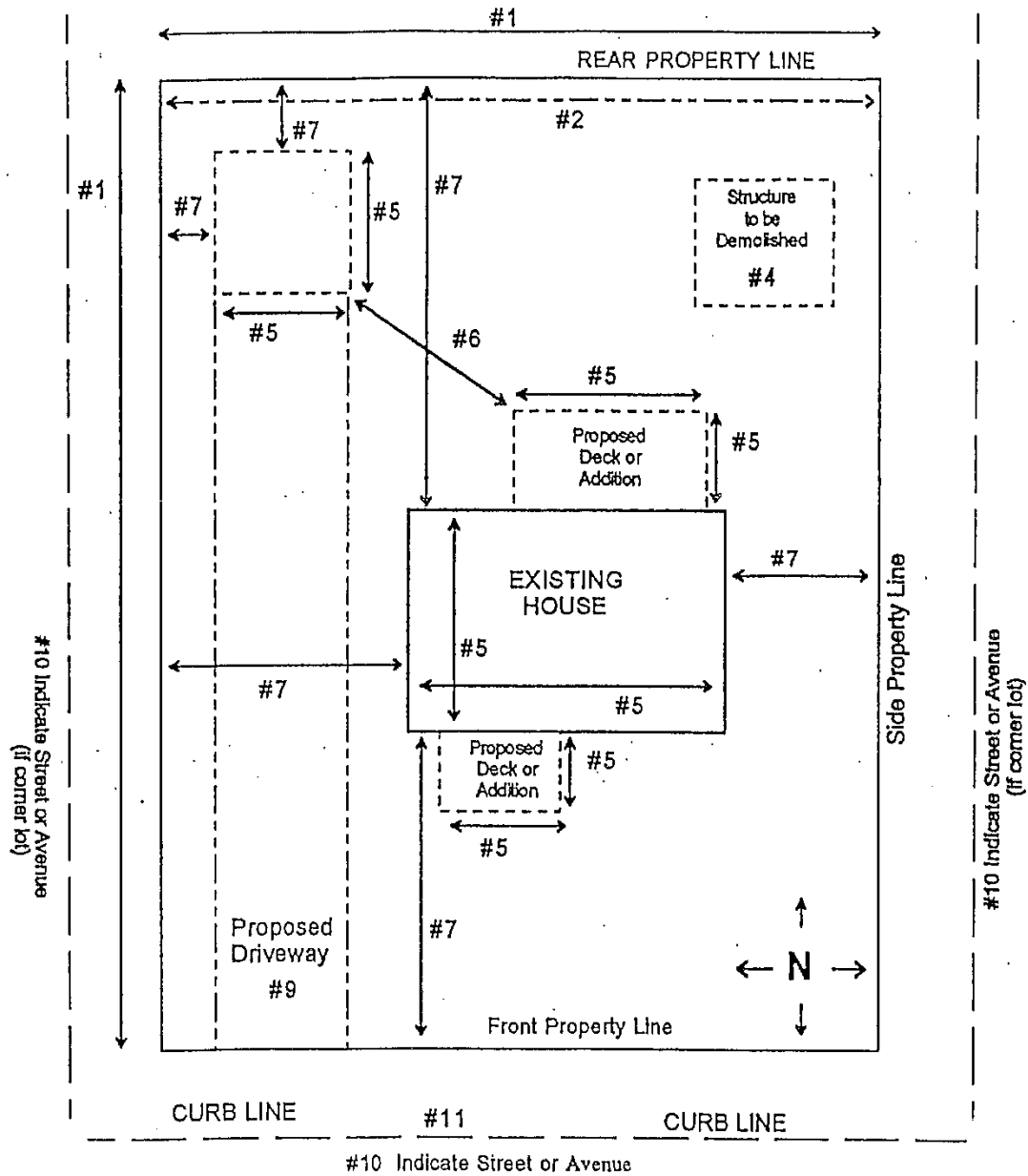

NOTE: ALL OF THESE ITEMS MUST BE SHOWN ON SITE PLAN SUBMITTED

1. Draw lot, show lot measurements and show all existing and proposed structures
2. Show all easements located on this lot
3. Label all existing and proposed structures
4. Show any buildings to be removed or demolished
5. Show dimensions of all structures
6. Show distance between all structures
7. Show distances between all structures and adjoining property line
8. Indicate North by circling appropriate arrow
9. Show existing driveway and any changes proposed to driveway.
10. Label adjacent street, if corner lot
11. NOTE: The Curb Line IS NOT the front property line.

**Describe how you will handle the following:**

Perimeter Drain Water

Eave Water

Sump Pump Water

Silt Screen Fence (if needed)

**Permit Fees**

**Residential building permits: 25 cents per square foot of building improvement proposed, with a \$50.00 minimum fee**

**Commercial building permit: 1/10 of 1% of the building improvement project or 10 cents per square foot of the same, whichever is greater, with a maximum fee of \$2000.00**

**The undersigned applicant, by signature, indicates his/her agreement to the conditions outlined in this permit, and will adhere to the Lake Park Zoning Regulations. The applicant also acknowledges understanding and agreement of:** *That this permit is valid ONLY for the project as presented to and approved by Lake Park; AND that any changes made to either the site plan submitted or the construction/improvement/usage authorized by this permit must be reviewed by Lake Park for compliance and authorization prior to commencement of construction; AND that it is the intent of the applicant to build the structure(s) noted on this form in accordance with the plan(s) submitted for the usage(s) indicated; AND that ANY unauthorized changes to the approved plan, usage noted, or to the parcel /land/site plan as presented renders this permit null and void.*

Permits shall be issued in conformance with the provisions of this ordinance, or upon written order from the Board of Adjustment, but shall be null and void if the purpose for which the permit is issued is not commenced within six months from the date the permit was approved or if the exterior of the permitted building or structure is not completed in finished form within twelve months of the permit approval date.

***Applicant Signature (or Authorized Representative)***

***Date***

**LAKE PARK ZONING COMPLIANCE PERMIT APPROVAL (FOR USE BY ZONING ADMINISTRATOR ONLY)**

This application and site plan presented by the applicant have been reviewed for compliance with the Lake Park Zoning Ordinance and is determined to be in compliance with the regulations.

This permit application is:  Approved  Denied as presented on this date: \_\_\_\_\_

Signed: \_\_\_\_\_ Lake Park Zoning Administrator

Copy Sent to Applicant on: \_\_\_\_\_

Zoning Permit Fee Paid:  Yes  No \$ \_\_\_\_\_

Special Exception Permit Required  Yes  No If Yes, forwarded to Board of Adjustment on \_\_\_\_\_ (date)



# CITY OF LAKE PARK

217 Market St. Box 536, Lake Park, IA 51347  
Phone: 712-832-3527 Fax: 712-832-3669

## PERMIT APPLICATION FOR SEWER CONNECTION

THE UNDERSIGNED APPLICANT, \_\_\_\_\_  
HEREBY APPLIES TO THE CITY OF LAKE PARK SANITARY SEWER SYSTEM.

1. ADDRESS \_\_\_\_\_  
\_\_\_\_\_
2. LEGAL DESCRIPTION OF PROPERTY \_\_\_\_\_  
\_\_\_\_\_
3. NUMBER OF UNITS OR BUILDINGS PROPOSED TO CONTRIBUTE THROUGH THIS  
CONNECTION \_\_\_\_\_
4. NAME AND ADDRESS OF PLUMBER TO MAKE CONNECTION \_\_\_\_\_  
\_\_\_\_\_
5. FROM WHAT SOURCE DO YOU OBTAIN WATER SUPPLY \_\_\_\_\_
6. IS THIS WATER METERED \_\_\_\_\_

APPLICANT AGREES IF PERMIT IS GRANTED HE/SHE WILL COMPLY WITH ALL ORDINANCES OF OF THE CITY OF LAKE PARK IN MAKING SAID CONNECTION **AND ALL INSTALLATIONS SHALL BE SUBJECT TO INSPECTION BY AN AUTHORIZED CITY OFFICIAL**, AND ACCEPTS RESPONSIBILITY OF MAINTENANCE AND RECONSTRUCTION OF THAT PORTION OF SAID CONNECTION.

DATE \_\_\_\_\_ APPLICANT \_\_\_\_\_

PERMIT IS HEREBY GRANTED TO \_\_\_\_\_, THE ABOVE NAMED APPLICANT TO MAKE CONNECTION OF SEWER FACILITIES ON HIS/HER PROPERTY, AS DESCRIBED ABOVE, SUBJECT TO ORDINANCE OF THE CITY OF LAKE PARK.

PERMIT FEE \_\_\_\_\_ 25.00 \_\_\_\_\_ CONNECT FEE \_\_\_\_\_ 200.00 \_\_\_\_\_

DATE \_\_\_\_\_ CITY OFFICIAL \_\_\_\_\_